

### Product description

The EC2 J, or more commonly known as the Hook-On panel, is a self-supporting panel overlapped with an invisible J-type supporting framing. The frames are perpendicular to the facades according to the layout plan. The panels are made of 5 to 8/10th thick steel sheet, perforated or not, with a wide choice of colours. The panels, with sharp, abutting edges, have two separate folds on either side of the panel, so that they can be positioned one on top of the other on the J-shaped support profile. Each panel can be dismantled by lifting and simultaneously handling the neighbouring panel. Access to the plenum for maintenance is simplified and the ceiling retains a monolithic appearance.



### Use

Rastered office tops, open-spaces, meeting rooms, computer rooms, etc.



### Materials

Galvanized steel 5/10 to 8/10.  
Depending on the width of the panels

Other materials on request



### Dimensions

Standard width 300 / 600 / 675 mm  
Other width on request  
Length within the limit of self-supporting  
(675 x 1800 mm maximum)



### Colors

- Pre-painted White 137 (~ RAL 9003)
- Post-painted, Polyseter powder coating RAL :



- Any other RAL colour on request



### Light reflection

CSTB report EMI 18-26077242-1 :  
Up to 88%, post painted RAL 9016  
Summary in the colors section of the catalogue



### Perforations

Standard :

On request:



11% Ø 1.5 M



2% Ø 0.8 U



22% Ø 1.5 M



16% Ø 2.5 U



Non perforated



Bending in perforation



Longitudinal perforation



Stopped 4 sides

Bespoke perforation ? Consult us !



### Options

- Special cut-outs for lighting and HVAC equipment on request
- Cooling ceiling



## Installation method

All special profiles available on request

### Installation in accordance with DTU 58.1

Frames : Panels installed under invisible Profile J PREV J type framework.  
Hanger at 1200 mm center distance with start 300 mm from the wall.  
The supporting profiles J are fixed perpendicularly under a commercial primary framework.

Edge : Installation of bins on simple edge angle.

Removal : Opening the EC2 J panel : Vertical thrust then lateral movement to escape the snapping profile.

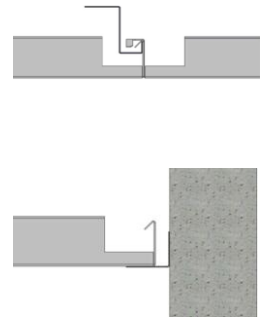

- 1 EC2 J Panel
- 2 REC L Edge corner
- 3- PREC J J Supporting profile



## Fire

Reaction to fire (according to EN 13501-1)

Euroclass A1 for the following products:

- non-perforated pre-painted panel
- pre-painted panel with non-woven fleece or surfaced rock wool lining

Euroclass A2-s1,d0 for products:

- Post-lacquered panels with or without lining



## Acoustics

Sound absorption measured in accordance with NF EN ISO 354. Acoustic certificates available on request.

Perforation 11% + black non-woven

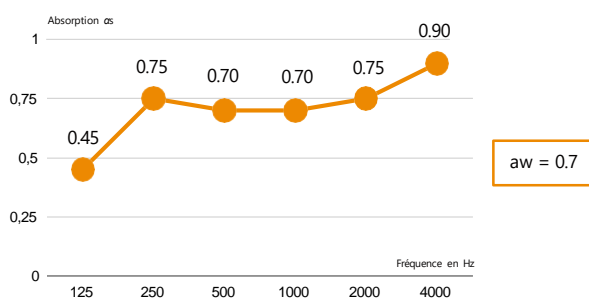

## Cleaning

Metal ceilings are resistant and easy to clean.  
For dust : Dry clean with a soft cloth or Hoover with a soft bristle brush.  
For stains : Clean with a damp cloth soaked in a non-abrasive cleaner diluted in water.  
For persistent, greasy stains, diluted alcoholic solutions can be used.



## Environment

100% recyclable ceiling, odourless, easy to maintain and does not generate dust, particles, or vapour.

No VOC or formaldehyde emissions.  
(Classification A for LR30)

ESDS sheet available on the INIES website ([www.inies.fr](http://www.inies.fr))



Perforation 11% + Rockwool 30 mm

