



### Product description

Self-supporting panels with straight upturned ends laid on a visible framework consisting of flat rails. The frames are perpendicular to the facades according to the layout plan. The panels are made of 5 to 8/10th thick steel sheet, perforated or not, with a wide choice of colours.

The panels have sharp, abutting edges and are folded up at each end to ensure rigidity.

The panels rest on flat rails or self-supporting edge angles.



### Use

Rastered office tops, open-spaces, meeting rooms, computer rooms, etc.



### Materials

Galvanized steel 5/10 to 8/10.

Depending on the width of the panels

Other materials on request



### Dimensions

Standard width 300 / 600 / 675 mm

Other width on request

Length within the limit of self-supporting (675 x 1800 mm maximum)



Sharp corner/  
optional longitudinal rod



### Colors

- Pre-painted White 137 (~ RAL 9003)

- Post-painted, Polyester powder coating RAL :

9003

9016

9010

9005

- Any other RAL colour on request



### Light reflection

CSTB report EMI 18-26077242-1 :

Up to 88%, post painted RAL 9016

Summary in the colors section of the catalogue



### Perforations

Standard :

On request:



11% Ø 1.5 M



2% Ø 0.8 U



22% Ø 1.5 M



16% Ø 2.5 U



Non perforated



Bending in perforation



Longitudinal perforation

Bespoke perforation ? Consult us !



### Options

Special cut-outs for lighting and HVAC equipment on request

Cooling ceiling

Heavy panels (L)

Fire stable panels (SF)

Long overlapping edge (BJR) for covering between panels



## Installation method

All special profiles available on request

### Installation in accordance with DTU 58.1

Frames : Panels laid on flat rails (various widths, with or without shadow gap)

Hanging positioned at 1200 mm centres, starting 300 mm from the wall.

The framing must be clamped using spacer profiles, such as counter-drilled angles, to prevent any movement of the framework that could cause the panels to fall.

Edges : Panels installed on single angle or hollow joint.

Removal : Open by pushing vertically on the panel.

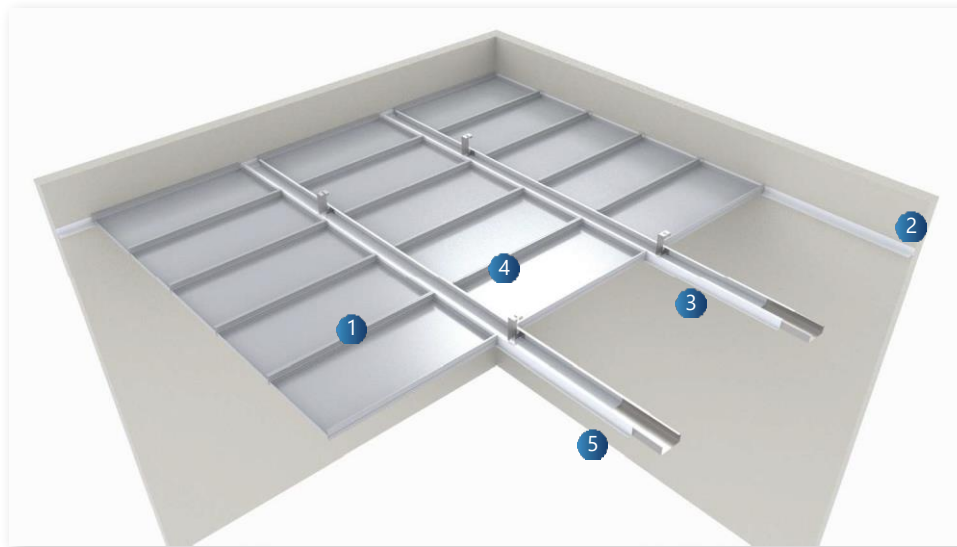
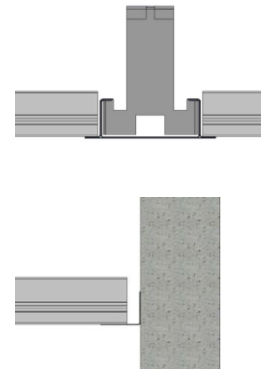

- 1 EC2 B0 Panel
- 2 REC L Edge corner
- 3 PREC LP Omega bandraستر
- 4 SUSP LP Bandraستر hanger
- 5 RACC LP Bandraستر connector



## Fire

Reaction to fire (according to EN 13501-1)

Euroclass A1 for the following products:

- non-perforated pre-painted panel
- pre-painted panel with non-woven fleece or surfaced rock wool lining

Euroclass A2-s1,d0 for products:

- Post-lacquered panels with or without lining



## Acoustics

Sound absorption measured in accordance with NF EN ISO 354. Acoustic certificates available on request.

Perforation 11% + black non-woven

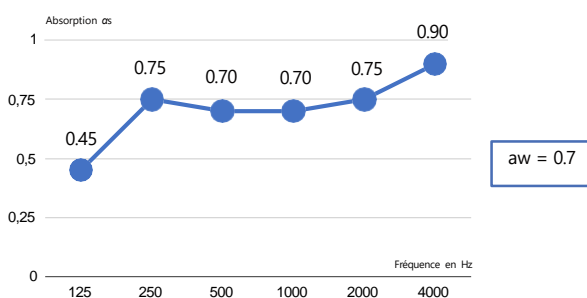

## Cleaning

- Metal ceilings are resistant and easy to clean.
- For dust : Dry clean with a soft cloth or Hoover with a soft bristle brush.
- For stains : Clean with a damp cloth soaked in a non-abrasive cleaner diluted in water.
- For persistent, greasy stains, diluted alcoholic solutions can be used.



## Environment

100% recyclable ceiling, odourless, easy to maintain and does not generate dust, particles, or vapour.

No VOC or formaldehyde emissions.  
(Classification A for LR30)

ESDS sheet available on the INIES website ([www.inies.fr](http://www.inies.fr))



Perforation 11% + Rockwool 30 mm

