



Product description

Economical, self-supporting open-ended trays on exposed edge profiles, installed in walkways only. The trays are made of 5/10th thick sheet steel, perforated or not, with a wide choice of colours.

The panels are open at both ends, with sharp, abutting edges.

The panels rest on self-supporting edge angles.



Use

Circulation areas, corridors.

Sanitary areas, small rooms requiring a self-supporting structure.



Materials

Galvanized steel 5/10.

Other materials on request



Dimensions

Standard width 300 mm
length within the limit of self-supporting
(2400 mm maximum)



Sharp corner/
optional longitudinal rod



Colors

- Pre-painted White 137 (~ RAL 9003)
- Post-painted, Polyester powder coating RAL :



- Any other RAL colour on request



Light reflection

CSTB report EMI 18-26077242-1 :
Up to 88%, post painted RAL 9016
Summary in the colors section of the catalogue



Perforations

Standard :

On request:



11% Ø 1.5 M



2% Ø 0.8 U



22% Ø 1.5 M



16% Ø 2.5 U



Non perforated



Bending in perforation



Longitudinal perforation

Bespoke perforation ? Consult us !



Options

Special cut-outs for lighting and HVAC equipment on request

Long overlapping edge (BJR) for covering between panels



Installation method

All special profiles available on request

Installation in accordance with DTU 58.1

Installation in walkways only

Edges : Panels installed on single angle, hollow joint, or runners.

Removal : Open by pushing vertically on the panel.

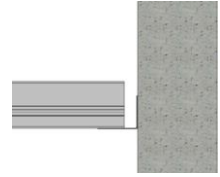

- 1 EC2 BO Panel
- 2 REC LEdge corner



Fire

Reaction to fire (according to EN 13501-1)

Euroclass A1 for the following products:

- non-perforated pre-painted panel
- pre-painted panel with non-woven fleece or surfaced rock wool lining

Euroclass A2-s1,d0 for products:

- Post-lacquered panels with or without lining



Acoustics

Sound absorption measured in accordance with NF EN ISO 354. Acoustic certificates available on request.

Perforation 11% + black non-woven

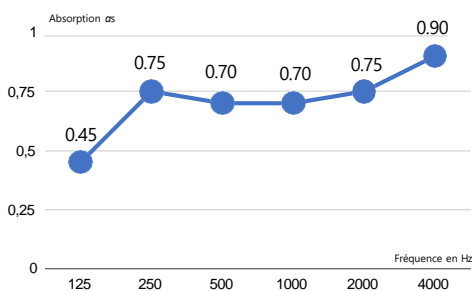

Cleaning

- Metal ceilings are resistant and easy to clean.
- For dust : Dry clean with a soft cloth or Hoover with a soft bristle brush.
- For stains : Clean with a damp cloth soaked in a non-abrasive cleaner diluted in water.
- For persistent, greasy stains, diluted alcoholic solutions can be used.



Environment

100% recyclable ceiling, odourless, easy to maintain and does not generate dust, particles, or vapour.

No VOC or formaldehyde emissions.
(Classification A for LR30)



ESDS sheet available on the INIES website (www.inies.fr)

Perforation 11% + Rockwool 30 mm

