



### Product description

The EC3 is a single-sided tilting panel that pivots on the pivot edge profile and remains suspended in the open position. It leaves the plenum completely free to access. This facilitates access to the technical networks and allows easy maintenance.

Special panels can be used to adapt to the shape of corridors, to accommodate direction changes. Lighting fittings or lighting strips can be integrated into the edge profiles.

The EC3 panel can also be used in office ceilings, where it can be installed in a shadow gap, using specific double hook profiles depending on the desired shadow gap.



### Use

Circulation ceilings for buildings such as hospitals, office buildings, shopping malls, etc.



### Materials

Galvanized steel 5/10 to 8/10.  
Depending on the width of the panels

Other materials on request



### Dimensions

Standard width 300 / 600 mm (Other width on request)

Length : 500 mm min – 2500 mm max

Height : 35 mm

Self supporting : 2500 x 600 mm max



### Colors

- Pre-painted White 137 (~ RAL 9003)
- Post-painted, Polyester powder coating RAL :



- Any other RAL colour on request



### Light reflection

CSTB report EMI 18-26077242-1 :  
Up to 88%, post painted RAL 9016  
Summary in the colors section of the catalogue



### Perforations

Standard :

On request:

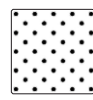

11% Ø 1.5 M

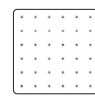

2% Ø 0.8 U

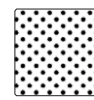

22% Ø 1.5 M

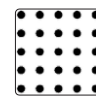

16% Ø 2.5 U



Non perforated

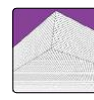

Bending in perforation

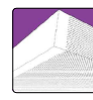

Longitudinal perforation



Stopped 4 sides

Bespoke perforation ? Consult us !



### Options

Special cut-outs for lighting and HVAC equipment on request

Fire stability ceiling (SF)

End of grid panel with the addition of an internal reinforcing crossbar



## Installation method

All special profiles available on request

Installation in accordance with DTU 58.1

In hallways: Panels installed on a specific EC3 ACCRO / PIVOT framing. To be bolted under the adjustment bracket fixed to the wall every 600 mm. The panels are installed with a minimum 25 mm hollow joint on each side.

The adjustment brackets are suspended from the concrete slab at their ends by a threaded rod with a 1200 mm pitch.

removal : Opening the EC3 panel: Push vertically on the kickplate side then move sideways to escape the hanging profile.

The panel remains suspended on the edge pivot profile.

The panel is closed by reversing the movement.

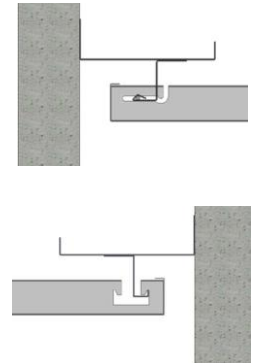

- 1 EC3 Panel
- 2 PREC PLR Bracket profile
- 3 PREC J Hook profile J
- 4 PREC PIV300 Pivot profile



## Fire

Reaction to fire (according to EN 13501-1)

Euroclass A1 for the following products:

- non-perforated pre-painted panel
- pre-painted panel with non-woven fleece or surfaced rock wool lining

Euroclass A2-s1,d0 for products:

- Post-lacquered panels with or without lining



## Acoustics

Sound absorption measured in accordance with NF EN ISO 354. Acoustic certificates available on request.

Perforation 11% + black non-woven

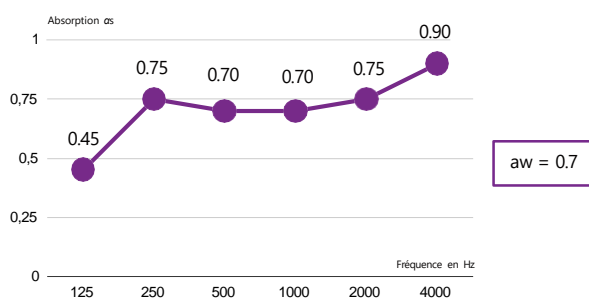

## Cleaning

Metal ceilings are resistant and easy to clean.

For dust : Dry clean with a soft cloth or Hoover with a soft bristle brush.

For stains : Clean with a damp cloth soaked in a non-abrasive cleaner diluted in water.

For persistent, greasy stains, diluted alcoholic solutions can be used.



## Environment

100% recyclable ceiling, odourless, easy to maintain and does not generate dust, particles, or vapour.

No VOC or formaldehyde emissions.  
(Classification A for LR30)

ESDS sheet available on the INIES website ([www.inies.fr](http://www.inies.fr))



Perforation 11% + Rockwool 30 mm

