

Product description

The EC30 SF is a tilting opening panel that pivots on the perimeter profile in two sides and remains suspended in the open position. It leaves the plenum completely free to access. This facilitates access to the technical networks and allows easy maintenance.

Designed for installation in the building corridors subject to fire stability requirements, it is simple to install and easy to dismantle to allow access to the plenum.



Use

Circulation ceilings for high-rise buildings subject to fire stability regulations.

In France, the decree of 22 March 2004 relating to the fire resistance of products, construction elements and works, requires a minimum stability of 15 min for circulation ceilings in high-rise buildings.



Materials

Galvanized steel 7/10 thickness.



Dimensions

Width : Up to 600 mm (SF R30)

Length on request : 500 mm minimum / 2345 mm maximum)

Height : 35 mm



Sharp corner



Colors

- Pre-painted White 137 (~ RAL 9003)

- Post-painted, Polyseter powder coating RAL :

9003

9016

9010

9005

- Any other RAL colour on request



Light reflection

CSTB report EMI 18-26077242-1 :

Up to 88%, post painted RAL 9016

Summary in the colors section of the catalogue



Perforations

Standard :

On request:



11% Ø 1.5 M



2% Ø 0.8 U



22% Ø 1.5 M



Non perforated



Bending in perforation



Longitudinal perforation

Non-standard perforation not available for the fire stability report.



Options

The ceiling and its framing must not support any load other than their own weight.

Miscellaneous equipment not included in the test assembly (lighting, ventilation, sound system, signs, etc.) may be hung from the main structure. may be attached to the main or secondary structure of the building using hangers. These can pass through the panel with a minimum of clearance. This secondary structure must then be hot-checked, by test or calculation in accordance with current standards.



Installation method

All special profiles available on request

The installation method must follow the recommendations in the CSTB test report (available on request):

Panels installed under PREC J profiles-sections specific to EC30.

These J-sections are bolted to a 40x133 mm adjustment bracket fixed to the wall with metal wall plugs every 600 mm and suspended from the ceiling by an M6 threaded rod at 1000 mm centres.

The panels are installed with a minimum 12 mm hollow joint on each side.

Removal : Opening the EC30 panels : Push vertically, then move sideways to escape the hanging profile.

The panel pivots and remains attached to the edge pivot profile.

The panel is closed by reversing the movement.

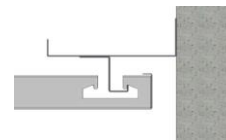

- 1 EC30 Panel
- 2 PREC PLR Bracket profile
- 3 PREC J Hook profile J



Fire

Reaction to fire (according to EN 13501-1)

Euroclass A1 for the following products:

- non-perforated pre-painted panel
- pre-painted panel with non-woven fleece or surfaced rock wool lining

Euroclass A2-s1,d0 for products:

- Post-lacquered panels with or without lining

Fire resistance (According to NF EN 13501-2 : 2016-07)

- EC30 SF : R 30 min (PV CSTB n°RS17-063)



Acoustics

Sound absorption measured in accordance with NF EN ISO 354. Acoustic certificates available on request.

Perforation 11% + black non-woven

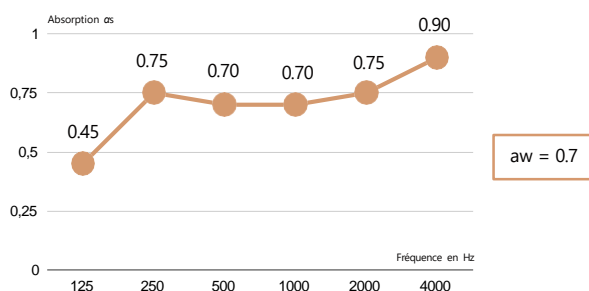

Cleaning

Metal ceilings are resistant and easy to clean.

For dust : Dry clean with a soft cloth or Hoover with a soft bristle brush.

For stains : Clean with a damp cloth soaked in a non-abrasive cleaner diluted in water.

For persistent, greasy stains, diluted alcoholic solutions can be used.



Environment

100% recyclable ceiling, odourless, easy to maintain and does not generate dust, particles, or vapour.

No VOC or formaldehyde emissions.
(Classification A for LR30)

ESDS sheet available on the INIES website (www.inies.fr)



Perforation 11% + Rockwool 30 mm

